

*Copied from
book, balance
missing*

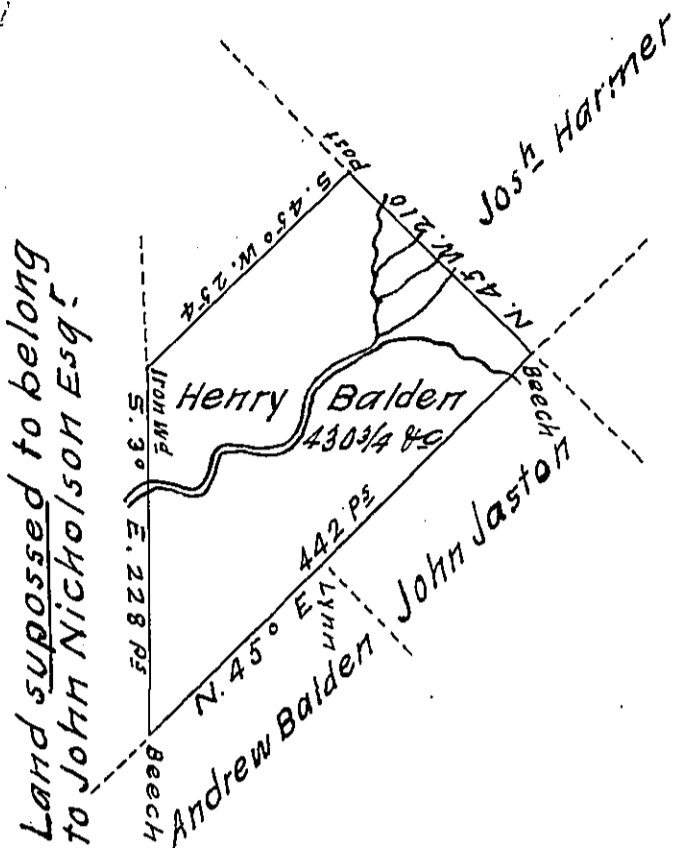

A draft of a tract of land called _____ situate on waters of a branch of Tunkhannock called Martins Creek joining land surveyed for Andth Balder and others in the County of Luzerne containing four hundred & thirty acres 3/4 & allowance of six & cent. for roads &c. surveyed for Henry Balder the 12th day of June 1789 in pursuance of a warrant dated the 6th day of May 1789

by Wm Gray D.S.

Daniel Brodhead Esq^r }
Surv^r Gen^l }

IN TESTIMONY that the above is a copy of the original remaining on file in the Department of Internal Affairs of Pennsylvania, made conformably to an Act of Assembly approved the 16th day of February, 1833, I have hereunto set my Hand and caused the Seal of said Department to be affixed at Harrisburg, this twenty seventh day of December.....1911

Henry Houch
Secretary of Internal Affairs.